

THE MASTER FLOOR PLAN SHOWS THE OVERALL BUILDING CONFIGURATION AND THE RELATIONSHIP OF THE SECTION PLANS WHICH FOLLOW. REFER TO LARGER SCALE PLANS AND PLAN DETAILS FOR ADDITIONAL INFORMATION AND CONSTRUCTION REQUIREMENTS. MASTER PLAN LEGENDS ALSO APPLY TO 1/8" SCALE SECTION FLOOR PLANS.

PLEASE NOTE:

- FIRE EXTINGUISHER**
 REF. SPEC. SECTION 10520.
 PROVIDE BLOCKING AND UNTEL. AS REQ'D. REF. ELEC. FOR PANEL SIZE.
- PROTECTION SCREEN** AS SPEC'D.
 REF. TYP. DET. TECHNOLOGY SHTS.
- P.S.**
 LIQUID CHALK SURFACE AS SPEC'D.
 LENGTH AS NOTED. REF. SHT. A2.1
- BACKBOARD** AS SPEC'D.
 LENGTH AS NOTED. REF. SHT. A2.1
- ELECTRIC WATER COOLERS**
 REF. PLUMBING PLAN
- TYPICAL E.W.C. INSTALLATION**
 INSTALL TWO ELECTRIC WATER COOLERS AS SPECIFIED AT EACH LOCATION (UNO.). MOUNT ONE (U.C. ON PLAN) AT ADA HEIGHT AND ONE AT STANDARD HEIGHT (REF. SPEC. SECTION - 01410). REFER TO MEP DRAWINGS FOR TYP. UTILITY CONNECTIONS. IF CONNECTIONS ARE OMITTED FROM MEP DRAWINGS, PROVIDE APPROPRIATE UTILITY CONNECTIONS FOR COMPLETE AND PROPER INSTALLATION TO NEAREST UTILITIES AVAILABLE (VERIFY).
- DOOR ASSEMBLY NUMBER**
 REFER TO SCHEDULE, SHEET A3.1 FOR DESCRIPTION.
- WINDOW ASSEMBLY NUMBER**
 REFER TO SCHEDULE, SHEET A3.2 FOR DESCRIPTION.
- SPECIAL OPENING NUMBER**
 REFER TO SCHEDULE, SHEET A3.1 FOR DESCRIPTION.
- INTERIOR ELEVATION REFERENCE**
 REFER TO SCHEDULE, SHEET A3.1 FOR DESCRIPTION.
- PLAN DETAIL REFERENCE**
 REFER TO SCHEDULE, SHEET A3.1 FOR DESCRIPTION.
- WALL SECTION REFERENCE**
 REFER TO SCHEDULE, SHEET A3.1 FOR DESCRIPTION.
- STRUCT. STEEL COLUMN**
 REF. STRUCT. DRAWINGS
- 1" E.C. 1" BUILDING EXPANSION JOINT**
 PROVIDE APPROPRIATE E.C. ASSEMBLY AT ALL EJ LOCATIONS. REFER TO SHEET A3.2 FOR TYPICAL DETAILS.
- REFER TO THE FOLLOWING SHEETS FOR TYPICAL ITEMS NOTED:
 METAL LOCKERS - A3.1
 TYP. ABREVIATIONS - A5.1 & A5.2
 FIRE RATED ASSEMBLIES - A1.3 & A1.4
 SOUND RATED ASSEMBLIES - A1.3 & A1.4

FLOOR PLAN LEGEND

- REF. SHT. A5.1 TYP. CONST. DETAILS FOR ADDITIONAL INFO.
- 4" MASONRY VENEER W/ C.M.U. WALL BACK UP**
 PROVIDE 2" AIR GAP @ EXT. WALLS. REFER TO WALL SECTIONS AND EXTERIOR ELEVATIONS FOR THICKNESS, MATERIAL TYPE AND CONSTRUCTION.
- C.M.U. PARTITION**
 REFER TO WALL SECTION OR PLAN DIMENSIONS AND NOTES FOR THICKNESS, TYPE AND CONSTRUCTION.
- DRYWALL PARTITION**
 REFER TO WALL SECTION OR PLAN DIMENSIONS AND NOTES FOR THICKNESS, TYPE AND CONSTRUCTION.
- CERAMIC TILE (PARTITION TYPE VARIES)**
 REFER TO ROOM FINISH SCHED. FOR CERAMIC TILE TYPES & HTS.
- NOTES:**
- ALL DRYWALL PARTITIONS ARE 5/8" GYP. BD. ON EACH SIDE OF 3-5/8" METAL STUDS UNLESS TUBE STEEL COLUMN IS BEING ENCASED, WHERE IT WOULD BE 5/8" GYP. BD. ON EACH SIDE OF 6" METAL STUDS.
 - THE INSIDE OF DRYWALL CHASES NEED NOT BE GYP. BD. UNLESS THAT PORTION OF THE CHASE IS PART OF A FIRE RATED ASSEMBLY.
 - NON-LOADBEARING CMU PARTITIONS ARE 8" CMU UNLESS NOTED OTHERWISE. WALL THICKNESSES NOTED ON PLANS ARE NOMINAL. REFER TO WALL SECTIONS FOR ADDITIONAL INFORMATION REGARDING THICKNESS AND MATERIALS.
 - REFER TO SOUND AND FIRE PARTITION PLAN FOR LOCATIONS OF SPECIAL PARTITIONS. REFER TO RELATED LEGEND AND TYPICAL WALL CONSTRUCTION DETAILS FOR REQUIREMENTS.
 - SEE WALL SECTIONS FOR CONSTRUCTION OF EXTERIOR WALLS.

PARTITION LEGEND

- ALL DIMENSIONS SHOWN ARE NOMINAL.
- ALL DIMENSIONS SHOWN ARE TO FACE OF GYP. BD., MASONRY, OR CONCRETE.
- SEE STRUCTURAL DRAWINGS FOR ADDITIONAL REINFORCEMENT REQUIREMENTS.
- SEE SPECIFICATIONS AND TYP. CONSTRUCTION DETAILS (A5 SHTS.) FOR ADDITIONAL MASONRY AND DRYWALL REQUIREMENTS.
- SEE PLUMBING PLANS AND ENLARGED FLOOR PLANS (SHT. A1.19 & A1.20) FOR EXACT LOCATION OF FIXTURES.
- REFER TO DOOR AND WINDOW SCHEDULES AND DETAILS (A3 SHTS.) FOR MASONRY ROUGH OPENING SIZES.
- VERIFY ALL MASONRY OPENINGS WITH MANUFACTURERS PRODUCTS (FIRE EXT. CAB'S, ELECTRICAL PANELS, ETC.).
- REFER TO SHEETS A1.3 & A1.4 FOR SOUND AND FIRE SEPARATION PARTITION PLANS.
- REFER TO SHEETS A2.8 - A2.19 FOR REFLECTED CEILING PLANS.
- REFER TO SHEETS A2.6 & 2.7 FOR FLOOR PATTERN PLANS.

GENERAL FLOOR PLAN NOTES

- PROVIDE (3) #5 BARS AT ALL CORNERS W/ GROUT
- PROVIDE (1) #5 BAR W/GROUT AT ALL OPENINGS 4'-4" OR LESS
- PROVIDE (2) #5 BARS W/ GROUT AT END OF WALLS OR OPENINGS GREATER THAN 4'-4"
- EXPANDED METAL LATH 12" LONG @ 16" O.C. VERT.
- PROVIDE 1-#5 BAR AND FILL CELLS SOLID W/ GROUT
- FOR TYPICAL MASONRY JOINT CONDITIONS, REFER TO SHT. A5.1
- TYP. C.M.U. WALL CONDITIONS**

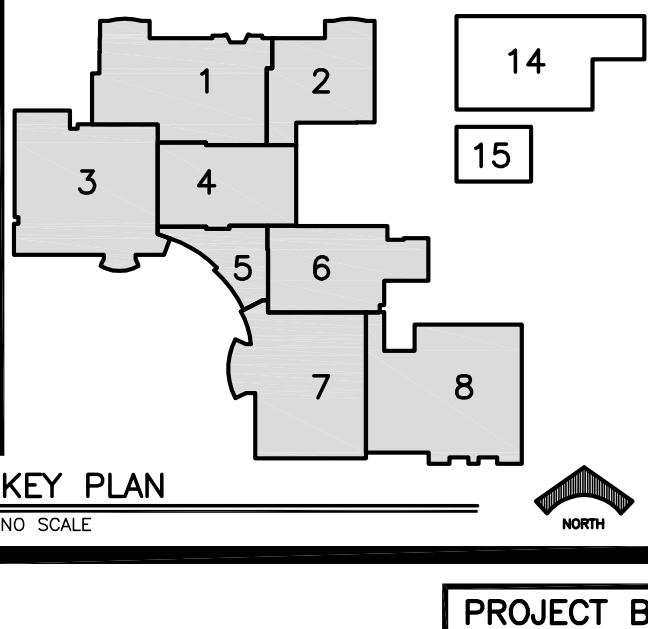

Copyright © 2007, Huckabee & Associates, Inc.

Project: ADDITIONS AND RENOVATIONS TO GRAHAM HIGH SCHOOL FOR GRAHAM I.S.D., GRAHAM, TEXAS

REGISTERED ARCHITECT
 STATE OF TEXAS
 16168

Huckabee
 ARCHITECTURE
 ENGINEERING
 MANAGEMENT

Austin
 Dallas
 Fort Worth

4521 South Hulen, Suite 220
 Fort Worth, Texas 76109
 ph 817.377.2969
 fx 817.377.2303
 www.huckabee-inc.com

Job No. 1593-02
 Drawn By: JCB
 Date: NOVEMBER 2, 2007

Sheet No. A1.1

Project B Sheet of